



Mobile Standard Construction and HEX-COR® augers have been tested in the field and independently tested in the laboratory and proven to be equal to or stronger than any other auger in the industry.

All Mobile continuous flight augers are manufactured through use of an automatic inert gas metal arc welding process to assure consistent high quality and maximum strength.

Flights are formed with a slightly tapered concave surface designed to throw cuttings toward the shaft, minimizing clogging and auger drag. Timed flight pitch is set at an optimum angle to produce the best conveyance of material for general auger exploration work and to maintain continuity of the flight spiral from one section to the next.

Uniform bead hardfacing, standard on HEX-COR® augers and optional on Standard Construction, ensures flight edges have sufficient chrome-manganese alloy for non-brittle toughness and greater resistance to abrasion.

Standard Construction augers are manufactured by conventional methods with the exception of the continuous flighting which is welded on both sides to the center shaft by an exclusive manufacturing process. The center shafts of Standard Construction augers are formed of high quality, low carbon steel tubing to provide minimum weight with maximum strength and rigidity.

Innovative HEX-COR® augers have many advantages over Standard Construction augers. In addition to superior strength, they have no shank/socket bulge to impede cutting conveyance and come with full length, flight-edge hardfacing standard. They are completely interchangeable with other augers of common shank and socket size, use all auger heads of matching shank design, and are easily repaired in the field.

The flighting and the center shaft, made of the highest quality steels, are welded into one unit utilizing inert gas metal arc welding. The center shaft tube of HEX-COR® auger is hex-pierced to the hex shank size throughout its length so that shanks simply slip into the center shaft. This design allows fast replacement of worn or broken shanks in the field.

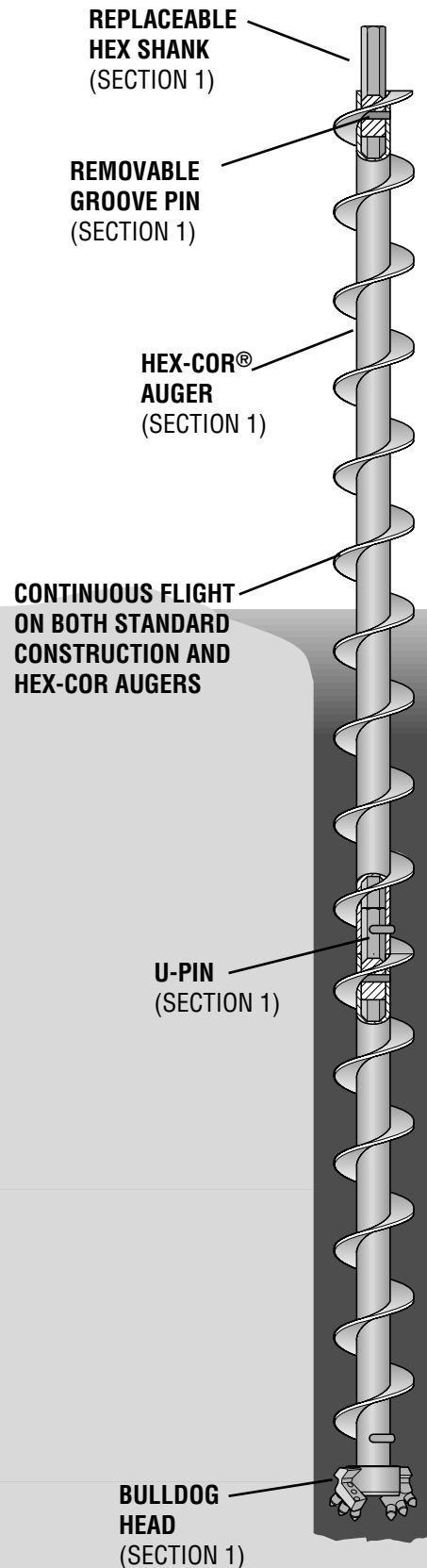

HEX-COR™ AUGERS

*Don't replace the entire auger, just the "shank" –
HEX-COR™ exclusively from Mobile*

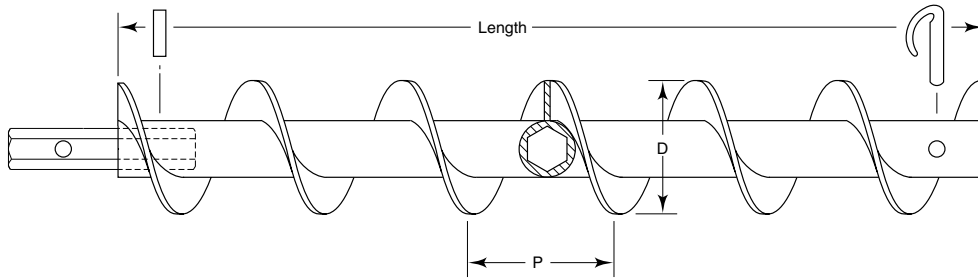

Available in Hole Sizes 2-1/2" (64 mm) through 12" (305 mm) Hex Sized 13/16", 1-1/8" and 1-5/8" (20.6 mm, 29 mm and 41 mm)

- Field replacement shank
- Internal hex tubing
- Hardfaced flight edges
- U-pin furnished with each section.

TUBING AISI 4130 Cold Drawn, Stress Relief Annealed, Steel Tubing

HEX SHANK Cold Drawn 13/16", 1-1/8" or 1-5/8" (20.6 mm, 28.6mm or 41.3 mm) Hexagon AISI 4140 Steel, Heat Treated

FLIGHT Hot Rolled Flat AISI 1020 Steel—Thickness 1/4" (6.35mm)

RETAINING PIN AISI 4140 Steel, Heat Treated to 43-48 Rockwell C-Scale

HOLE SIZE		"D" DIAMETER		"P" PITCH		HEX CONN.		STOCK LENGTH		WEIGHT		PART NUMBER	SERIES
in	mm	in	mm	in	mm	in	mm	ft	m	lb	kg		
2-1/2	64	2-3/8	60	2	51	13/16	21	3	.91	12	5.4	001165	1125
								5	1.5	18	8.2	001167	
3	76	2-5/8	67	2	51	13/16	21	3	.91	14	6.4	001168	
								5	1.5	22	10.0	001170	
3-1/2	89	3-1/4	83	3-1/3	85	1-1/8	29	3	.91	18	8.2	001171	
								5	1.5	30	13.6	001173	
								10	3.1	61	27.7	004811	
3-3/4	95	3-1/2	89	3-1/3	85	13/16	21	3	.91	18	8.2	BKNFOLLY	1500
4-1/2	114	4	102	3-1/3	85	1-1/8	29	3	.91	22	10.0	001174	
								5	1.5	34	15.4	001176	
								10	3.1	70	31.8	004812	
5	127	4-1/2	114	4	102	1-1/8	29	3	.91	27	12.2	001177	
								5	1.5	36	16.3	001179	
6	152	5-1/2	140	5	127	1-1/8	29	3	.91	26	11.8	001180	
								5	1.5	40	18.1	001182	
4-1/2	114	4	102	3-1/3	85	1-5/8	41	3	.91	+	+	007208	2000
								5	1.5	54	24.5	001185	
								10	3.0	104	47.2	001186	
5	127	4-1/2	114	4	102	1-5/8	41	5	1.5	54	24.5	001189	
								10	3.0	106	48.1	001190	
6	152	5-1/2	140	5	127	1-5/8	41	5	1.5	58	26.3	001191	
								10	3.0	115	50.3	001192	
7	178	6	152	5	127	1-5/8	41	5	1.5	64	29.0	001193	
8	203	7	178	7	178	1-5/8	41	5	1.5	72	32.7	001195	
								10	3.0	139	63.0	001196	
10	254	8-1/2	225	7	178	1-5/8	41	5	1.5	+	+	007240	
12	305	10	254	8	203	1-5/8	41	5	1.5	+	+	007241	

Special sizes available upon request – based on minimum order quantities.

HEX-COR™ AUGERS — METER LENGTHS — FOR INTERNATIONAL REQUIREMENTS

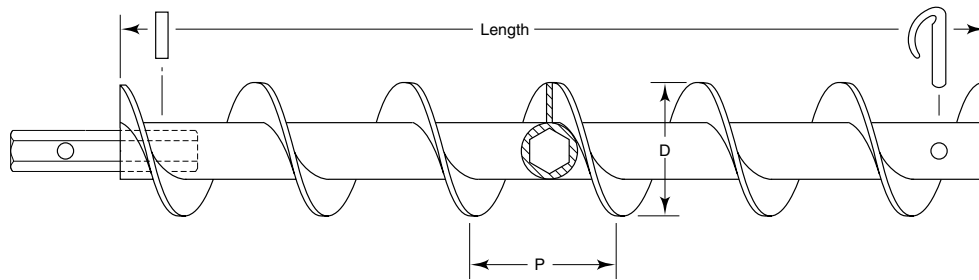

Available in Hole Sizes 4-1/2" (114mm) through 12" (305mm) Hex Sized 13/16", 1-1/8" and 1-5/8" (20.6mm, 29mm and 41mm)

- Field replacement shank
- Internal hex tubing
- Hardfaced flight edges
- U-pin furnished with each section.

TUBING AISI 4130 Cold Drawn, Stress Relief Annealed, Steel Tubing

HEX SHANK Cold Drawn 13/16", 1-1/8" or 1-5/8" (20.6mm, 28.6mm or 41.3mm) Hexagon AISI 4140 Steel, Heat Treated

FLIGHT Hot Rolled Flat AISI 1020 Steel—Thickness 1/4" (6.35mm)

RETAINING PIN AISI 4140 Steel, Heat Treated to 43-48 Rockwell C-Scale

HOLE SIZE		"D" DIAMETER		"P" PITCH		HEX CONN.		STOCK LENGTH	WEIGHT		PART NUMBER	SERIES
in	mm	in	mm	in	mm	in	mm	m	lb	kg		
4-1/2	114	4	102	3-1/3	85	1-1/8	29	1	+	+	150473-01	1500
								3	+	+	150473-02	
5	127	4-1/2	114	4	102	1-1/8	29	1	+	+	150473-03	
								3	+	+	150473-04	
4-1/2	114	4	102	3-1/3	85	1-5/8	41	1	+	+	150744-01	2000
								3	+	+	150744-02	
5	127	4-1/2	114	4	102	1-5/8	41	1	+	+	150744-03	
								3	+	+	150744-04	
7	178	6	152	5	127	1-5/8	41	1	+	+	150744-05	
								3	+	+	150744-06	
8	203	7	178	7	178	1-5/8	41	1	+	+	150744-07	
								3	+	+	150744-08	
10	254	8-7/8	225	7	178	1-5/8	41	1	+	+	150744-09	
								3	+	+	150744-10	
12	305	10	254	8	203	1-5/8	41	1	+	+	150744-11	
								3	+	+	150744-12	

Special sizes available upon request – based on minimum order quantities.

COMPONENT PARTS

Ref	Description	Lb/Kg	Part No.
1	U-Pin (1125 Series), 13/16" (21mm) Hex *		001305
1	U-Pin (1500 Series), 1-1/8" (29mm) Hex .. *		001306
1	U-Pin (2000 Series), 1-5/8" (41mm) Hex .. *		001307
2	Groove Pin, 13/16" (21mm) Hex	*	150279
2	Groove Pin, 1-1/8" (29mm) Hex	*	150280
2	Groove Pin, 1-5/8" (41mm) Hex	1 (.5)	150281
3	Repair Shank, 13/16" (21mm) Hex	1 (.5)	003997
3	Repair Shank, 1-1/8" (29mm) Hex	2 (.9)	003996
3	Repair Shank, 1-5/8" (41mm) Hex	5 (2.3)	003995

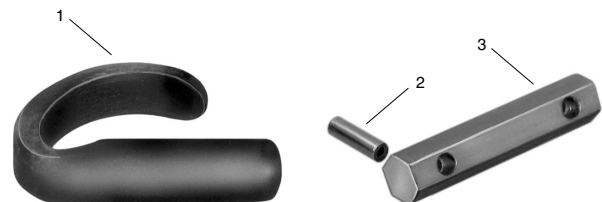



STANDARD CONSTRUCTION AUGERS

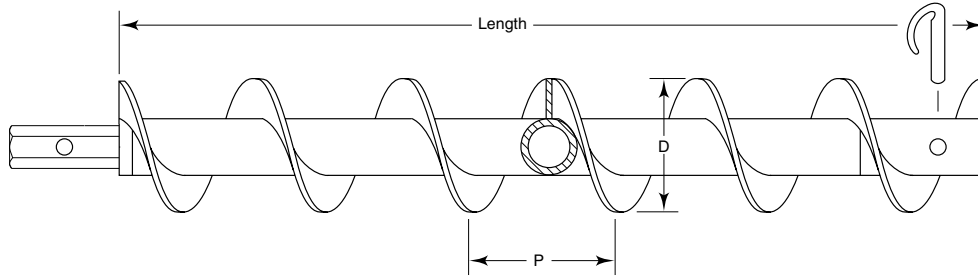

The hex shank and socket connector are welded to the auger and a U-Pin connector is supplied with each auger section.
Hardfacing of flight edges is available at an additional cost; please contact factory. Larger diameters up to 24" (610mm) are available on request, based on minimum order quantities. Special lengths are available in 10" (254mm) and 12" (305mm) diameters only. For other special lengths, see **HEX-COR™** augers, Section 1. **Sizes are identified by the hole size, not actual flight diameter.**

HOLE SIZE		"D" DIAMETER		"P" PITCH		HEX CONN.		STOCK LENGTH		WEIGHT		PART NUMBER	SERIES	
in	mm	in	mm	in	mm	in	mm	ft	m	lb	kg			
4-1/2	114	4	102	3-1/3	85	1-5/8	41	5	1.5	42	19.1	004360	2000	
								10	3.0	†	†	004361		
5	127	4-1/2	114	4	102	1-5/8	41	5	1.5	44	20.0	004364		
6	152	5-1/2	140	5	127	1-5/8	41	5	1.5	48	21.8	004366		
								10	3.0	†	†	004367		
7	178	6	152	5	127	1-5/8	41	5	1.5	54	24.5	004368		
8	203	7	178	7	178	1-5/8	41	3	.91	†	†	150254-03		
								5	1.5	60	27.2	004370		
10	254	8-7/8	225	8	203	1-5/8	41	5	1.5	90	40.8	004374		2875
								10	3.0	127	57.6	004375		
12	305	10	254	9	229	1-5/8	41	5	1.5	102	46.3	004376		
								10	3.0	135	61.2	004377		
6	152	5-1/2	140	5	127	2	51	5	1.5	68	30.8	003472	2625	
8	203	7	178	7	170	2	51	5	1.5	74	33.6	003474		
10	254	8-7/8	225	8	203	2	51	5	1.5	104	47.2	003475		
12	305	10	254	8	203	2	51	5	1.5	112	55.3	003476		
14	356	12	305	9	229	2	51	5	1.5	139	63.1	004975		

COMPONENT PARTS

Ref	Description	Lb/Kg	Part No.
1	U-Pin (2000 Series) 1-5/8" (41mm) Hex...*		001307
1	U-Pin 3-1/2" (89mm) 2625 & 2875 Series		* 001308
1	U-Pin 4-1/2" (114mm) 2875 Series		* 004620
2	Repair Shank 13/16" (21mm) Hex.....*		001336
2	Repair Shank 1-1/8" (29mm) Hex		* 001337
2	Repair Shank 1-5/8" (41mm) Hex	7 (3.2)	001338
2	Repair Shank 2" (51mm) Hex.....	12 (5.4)	003479
3	Repair Socket 13/16" (21mm) Hex.....	2 (.9)	001340
3	Repair Socket 1-1/8" (29mm) Hex.....*		001341
3	Repair Socket 1-5/8" (41mm) Hex	4 (1.8)	150324
3	Repair Socket 2" (51mm) Hex.....	6 (2.7)	003478

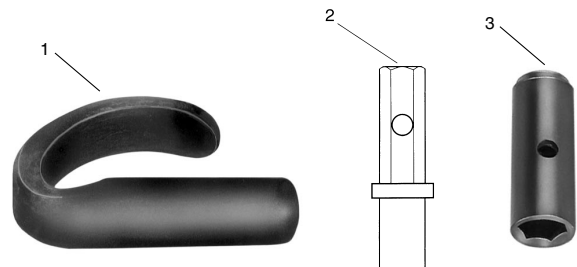

FINGER BIT TYPE MULTI-PURPOSE

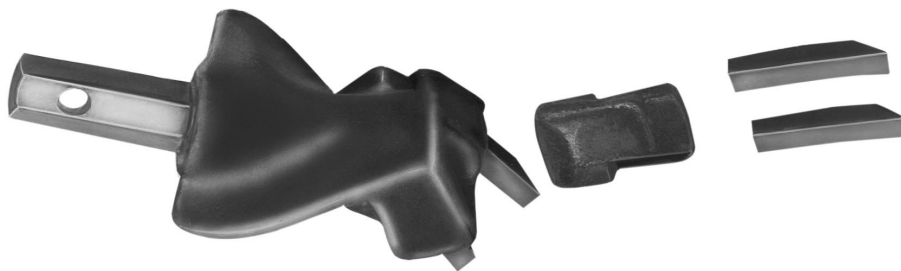

A tough, multi-purpose auger head for full range drilling. Uses replaceable borium or carbide insert bits depending upon the formation encountered. Borium tip bits are suitable for work in light to moderate soil formations such as silt, sand, fine gravel and shale. Tungsten carbide bits are used for more abrasive conditions or for longer bit life in any of the above formations, but are not recommended for nonuniform formations such as gravel where impact or shock might be encountered. Bits are held in place by malleable iron bit wedges that deform as necessary to grip bits within the head. Cutterhead sizes are identified by the hole size, not actual flight diameter.

HOLE SIZE		HEX CONNECTOR		WEIGHT		NO. BITS PER HEAD	HEAD WITH 006000 BITS	HEAD WITH 006002 BITS	NO. WEDGES REQUIRED	USES WEDGE PART NO.
in	mm	in	mm	lb	kg					
4-1/2	114	1-1/8	29	9	4.1	4	001536	001536-01	2	005474
5	127	1-1/8	29	11	5.0	6	006959	006959-01	2 and 2	005477 & 78
6	152	1-1/8	29	17	7.7	8	001540	001540-01	4	005477
4-1/2	114	1-5/8	41	11	5.0	4	001538	001538-01	2	005474
5	127	1-5/8	41	12	5.4	6	006960	006960-01	2 and 2	005477 & 78
6	152	1-5/8	41	19	8.6	8	001543	001543-01	4	005477
7	178	1-5/8	41	21.5	9.8	8	001544	001544-01	4	005477
8	203	1-5/8	41	21	9.5	10	001545	001545-01	4 and 2	005477 & 78
10	254	1-5/8	41	24	10.9	12	001547	001547-01	6	005477
12	305	1-5/8	41	27	12.2	14	001548	001548-01	6 and 2	005477 & 78
6	152	2	51	21	9.5	8	003480	003480-01	4	005477
8	203	2	51	24	10.9	10	003482	003482-01	4 and 2	005477 & 78
10	254	2	51	27	12.2	12	003483	003483-01	6	005477
12	305	2	51	29	13.1	14	003484	003484-01	6 and 2	005477 & 78

COMPONENT PARTS

Ref	Description	Lb/Kg	Part No.
1	Wedge Bit 4-1/2" (114mm)		
	Head Only	*	005474
1	Wedge Bit (Double).....	*	005477
1	Wedge Bit (Single).....	*	005478
2	Finger Bit, Barium Tip	*	006000
2	Finger Bit, Carbide Insert	*	006002

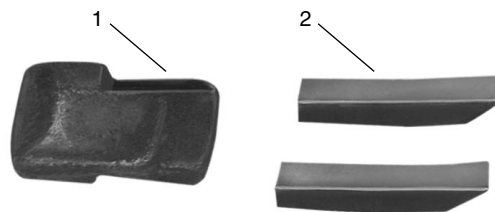



BULLDOG HEAD



A tough, multi-purpose auger head for full range drilling. Uses replaceable cone-shaped carbide insert bits depending upon the formation requirements. Bits are designed to revolve during the cutting action for a more uniform wear pattern and longer service life. Recommended for abrasive conditions and difficult hard formations. **Note:** Bits are furnished with lock rings installed. Drill head O.D. is approximately 10% larger than corresponding auger flight O.D. Sizes are identified by the hole size, not actual flight diameter.

Bulldog Cutterhead Assembly

Used with	HEX CONN.		WEIGHT		No. BITS PER HEAD	Part No.
	in	mm	lb	kg		
4-1/2" (114mm) hole size flight auger	1-1/8	29	9	4.0	6	61017-04
4-1/2" (114 mm) hole size flight auger	1-5/8	41	10	4.5	6	61017-14
6" (152 mm) hole size flight auger	1-1/8	29	13.5	6.1	8	61017-06
6" (152 mm) hole size flight auger	1-5/8	41	16	7.3	8	61017-16
6" (152 mm) hole size flight auger	2	51	20.0	9.1	8	61017-25

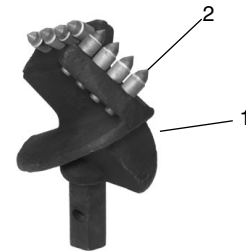

COMPONENT PARTS

Ref	Description	Lb/Kg	Part No.
1	HF Cutterhead Body: 4-1/2" (114mm), 1-1/8" (29mm) Hex.....8 (3.6).....		150230-01
1	HF Cutterhead Body: 4-1/2" (114mm), 1-5/8" (41mm) Hex.....9 (4.1).....		150231-01
1	HF Cutterhead Body: 6" (152mm), 1-5/8" (41mm) Hex.....16 (7.3).....		150228-01
1	HF Cutterhead Body: 6" (152mm), 2" (51mm) Hex.....18 (8.2).....		150229-01
2	BULLDOG Bit, Carbide Insert.....*		150233

MINING BIT

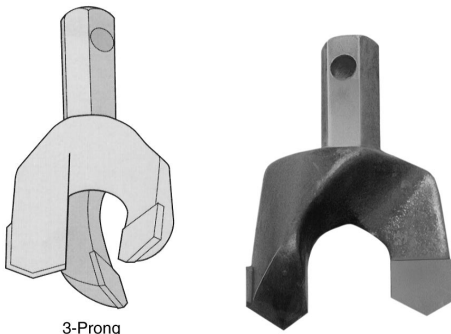

3-Prong

Bit prongs with brazed-on tungsten carbide inserts are set to "bite" for maximum penetration and minimum machine load. Recommended for medium hard non-uniform formation. Especially good for small bore horizontal or vertical holes. **Note:** 3 3/4" (95.2mm) bit recommended for 3 1/2" (88.9mm) hole size auger. Sizes are identified by the hole size, not actual flight diameter.

HOLE SIZE		HEX CONNECTOR		WEIGHT		ASSEMBLY PART NO.	NO. OF INSERTS	EXTRA INSERTS PART NO.	EXTRA CORE BREAKER PART NO.
in	mm	in	mm	lb	kg				
2	51	13/16	21	1	.45	004981	2	001457	None
2-1/2	64	13/16	21	1	.45	004982	2	001457	None
3	76	13/16	21	1	.45	001445	2	001457	None
3	76	1-1/8	29	1	.45	200024	2	001457	None
3-1/2	89	1-1/8	29	2	.91	004304	1 ea	004305 & 4306	None
*3-3/4	95	1-1/8	29	4.2	1.0	001447	3	001459	001471

*3-Prong.

MOBILE B-T ROCK HEAD



Recommended for frozen ground, all types of stone, quartz, cemented formations, boulder-laden soils and stump removal. Tungsten carbide bits are positioned to divide the formation into a series of narrow ledges and destroy the cohesive strength of the hardest material for faster, more efficient cutting. Hammer, punch and Allen wrench are the only tools needed to reposition the triangular six-in-one-bits. Designed for use with standard construction and **HEX-COR™** augers and as a pilot bit with large diameter hollow stem augers. B-T heads are available on special order with various shank sizes and shapes. Also available bored and shanked for A.P.I. auger or drill pipe. Assembly part number includes full sets of drill bits, clamps and pilot point. **Sizes are identified by the hole size, not actual flight diameter.**

HOLE SIZE		HEX CONNECTOR		WEIGHT		ASSEMBLY PART NO.	ASSEMBLIES REQUIRED
in	mm	in	mm	lb	kg		
4	102	1-1/8	29	13	5.9	001497	1
4	102	1-5/8	41	18	8.2	004628	1
6	152	1-5/8	41	25	11.3	001498	2
6	152	2	51	27	12.2	004629	2
8	203	1-5/8	41	27	12.2	001499	3
8	203	2	51	30	13.6	004630	3
10	254	1-5/8	41	35	15.9	001500	4
10	254	2	51	36	16.3	004631	4
12	305	1-5/8	41	39	17.7	001501	5
12	305	2	51	40	18.1	004632	5

COMPONENT PARTS

Ref	Description	Lb/Kg	Part No.
1	Block Assembly (Parts 3-9)..... *		005464
2	Pilot Point Assembly (Parts 3,4,6,10,11 & 12)..... *		004857
3	Clamp Bolt..... *		004637
4	Allen Nut..... *		004640
5	Clamp..... *		004638
6	Carbide Insert Type Tip..... *		001504
7	Bit Block..... *		004633
8	Tapered Washer..... *		004635
9	Bolt & Lock Washer..... *		004636
10	Lock Pin..... *		004634
11	Pilot Point..... *		004639
12	Heavy Duty Narrow Clamp (Not shown for Pilot Point)..... *		006563

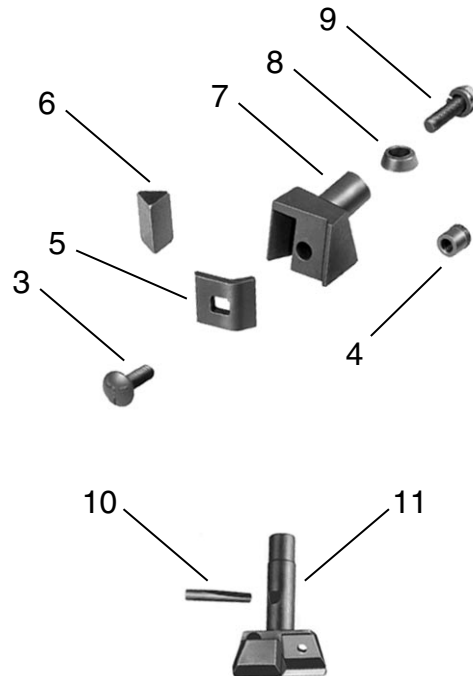



MOBILE D-P ROCK HEAD



The Mobile D-P cutterhead is constructed of high tensile steel and has milled surfaces to ensure accurate bit alignment. Each shank is keyed and welded securely to the head. Tough, carbide insert bits are induction brazed for smoother, faster cutting and up to 70% longer life in the hardest formations. D-P Rock heads are recommended for use in soft shales, soft limestone and other low compressive strength rocks. Assembly part number includes full set of bits and bit punch. **Sizes are identified by the hole size, not actual flight diameter.**

ACCESSORIES

Description	Lb/Kg	Part No.
D-P Bit Punch	*	004626
D-P Bit.....	*	004627

HOLE SIZE		HEX CONNECTOR		WEIGHT		ASSEMBLY PART No.	NUMBER OF BITS REQUIRED	BIT PART No.
in	mm	in	mm	lb	kg			
4-1/2	114	1-1/8	29	7	3.2	001481-10	5	004627
4-1/2	114	1 5/8	41	8	3.6	001482-10	5	
6	152	1-1/8	29	14	6.4	001483-10	7	
6	152	1-5/8	41	14	6.4	001484-10	7	
6	152	2	51	17	7.7	004623	7	
8	203	1-5/8	41	26	11.8	001486-10	11	
8	203	2	51	27	12.3	004625	11	
9	229	1-5/8	41	†	†	150746	†	
9	229	2	51	†	†	150747	†	
10	254	1-5/8	41	†	†	150748	†	
10	254	2	51	†	†	150749	†	

Assembly part number includes full set of bits.

TWO-PIECE FISHTAIL HEAD WITH CAST STEEL BLADES



Especially designed cast steel bit eliminates “dead-spot” at hole center and bores clean, straight holes through semi-consolidated clay, loam, sand, gravel and similar formations. Cutterhead part number includes bit and shank complete. Bolt and nut included in assembly. **Sizes are identified by the hole size, not actual flight diameter.**

COMPLETE HEAD WITH BIT							BIT ONLY			SHANK ONLY		
HOLE SIZE		HEX CONN.		WEIGHT		PART NO.	WEIGHT		PART NO.	WEIGHT		PART NO.
IN	MM	IN	MM	LB	KG		LB	KG		LB	KG	
2	51	13/16	51	1.5	.68	004563	*	*	004575	*	37	004586
2	51	1-1/8	29	1.5	.68	004564	*	*	004575	.8	37	004587
2-1/2	64	13/16	21	2	.9	001435	*	*	004575	.8	37	004586
2-1/2	64	1-1/8	29	2.3	1.0	004565	*	*	004575	1.5	.68	004587
3	76	13/16	21	2	.9	001436	1	.45	004577	.8	.37	004586
3	76	1-1/8	29	3	1.4	004566	1	.45	004577	1.5	.68	004587
3-1/2	89	1-1/8	29	3	1.4	001437	2	.9	004578	1.5	.68	004588
4-1/2	114	1-1/8	29	5	2.3	001438	3	1.4	004579	1.5	.68	004588
4-1/2	114	1-5/8	41	6	2.7	004567	3	1.4	004579	3	1.4	004589
5	127	1-1/8	29	5	2.3	001439	3	1.4	004580	1.5	.68	004590
5	127	1-5/8	41	7	3.2	004568	3	1.4	004580	3	1.4	004591
6	152	1-1/8	29	5	2.3	001440	4	1.8	004581	1.5	.68	004590
6	152	1-5/8	41	8	3.6	004569	4	1.8	004581	3	1.4	004591
6	152	2	51	11	5.0	004570	4	1.8	004581	4.5	2.0	004592
7	178	1-5/8	41	9	4.1	001441	4.5	2.0	004582	3	1.4	004591
8	203	1-5/8	41	9	4.1	001442	5	2.3	004583	3	1.4	004591
8	203	2	51	12	5.4	004572	5	2.3	004583	4.5	2.0	004592
10	254	1-5/8	41	11	5.0	001444	7	3.2	004585	3	1.4	004591
10	254	2	51	14	6.4	004574	7	3.2	004585	4.5	2.0	004592
12	305	1-5/8	41	†	†	150750	†	†	150572	†	†	004591
12	305	2	51	†	†	150751	†	†	150572	†	†	004592



TWO-PIECE FISHTAIL HEAD WITH CARBIDE INSERT BLADE



Carbide insert blade is recommended for stiff clay, soft shale and similar formations. Cutterhead part number includes bit and shank complete. Locking bolt and nut included in assembly. **Sizes are identified by the hole size, not actual flight diameter.**

COMPLETE HEAD WITH BIT							BIT ONLY			SHANK ONLY		
HOLE SIZE		HEX CONN.		WEIGHT		PART NO.	WEIGHT		PART NO.	WEIGHT		PART NO.
IN	MM	IN	MM	LB	KG		LB	KG		LB	KG	
2-1/2	64	13/16	21	2	.9	007122	*	*	007123	*	*	004586
2-1/2	64	1-1/8	29	2	.9	007124	*	*	007123	2	.9	004587
3	76	13/16	21	2	.9	007248	1	.5	007147	*	*	004586
3	76	1-1/8	29	3	1.4	007149	1	.5	007147	2	.9	004587
3-1/2	89	1-1/8	29	3	1.4	007125	2	.9	007126	2	.9	004588
4-1/2	114	1-1/8	29	5	2.3	007127	3	1.4	007128	2	.9	004588
4-1/2	114	1-5/8	41	6	2.7	007129	3	1.4	007128	3	1.4	004589
5	127	1-1/8	29	5	2.3	007130	4	1.8	007131	2	.9	004590
5	127	1-5/8	41	6	2.7	007132	4	1.8	007131	3	1.4	004591
6	152	1-1/8	29	5	2.3	007133	4	1.8	007134	2	.9	004590
6	152	1-5/8	41	7	3.2	007135	4	1.8	007134	3	1.4	004591
6	152	2	51	11	5.0	007136	4	1.8	007134	7	3.2	004592
7	178	1-5/8	41	8	3.6	007137	5	2.3	007138	3	1.4	004591
8	203	1-5/8	41	8	3.6	007139	5	2.3	007140	3	1.4	004591
8	203	2	51	12	5.4	007141	5	2.3	007140	7	3.2	004592
10	254	1-5/8	41	9	4.1	007142	6	2.7	007143	3	1.4	004591
10	254	2	51	13	5.9	007144	6	2.7	007143	7	3.2	004592

STINGER™ BIT



The STINGER's self-centering one-piece, cast steel construction with a smooth contoured shape permits free flow of material to the auger flight. Interchangeable with the two-piece Fishtail bit, it works well in clay, loam, sand, gravel and similar formations. Designed for use with standard construction and **HEX-COR™** augers and as a pilot bit with large diameter hollow stem augers. **Sizes are identified by the hole size, not actual flight diameter.**

HOLE SIZE		HEX CONN.		WEIGHT		PART NO.	HOLE SIZE		HEX CONN.		WEIGHT		PART NO.
in	mm	in	mm	lb	kg		in	mm	in	mm	lb	kg	
2-1/2	64	13/16	21	1.0	.45	005502	5	127	1-1/8	29	3.7	1.7	005509
3	76	13/16	21	1.2	.54	005504	6	152	1-1/8	29	6.4	2.9	005511
3	76	1-1/8	29	1.7	.76	005505	6	152	1-5/8	41	7.3	3.3	005512
4-1/2	114	1-1/8	29	3.4	1.73	005507	6	152	2	51	10.8	4.9	005513
4-1/2	114	1-5/8	41	5.0	2.3	005508							

MOBILOK™ JET AUGER

The premier retraction grouting tool for overburden applications with augers.

MOBILOK jet augers are designed for wet or dry hard formation drilling in lime rock, bauxite or like materials. Premium MOBILOK drill rod "J" Series is used for the center stem and allows for circulation of drilling mud, grout or fresh water to aid in well installation or tie-back. Excellent auger for use during retraction grouting if ENVIRO-CORE® is not at the site. Flight edges are hardfaced for wear resistance. Heavy wall couplings and tapered threaded connections provide an extra strong, water tight joint and speed "making and breaking" joints. **MOBILOK jet augers are identified by the hole size, not actual flight diameter.**

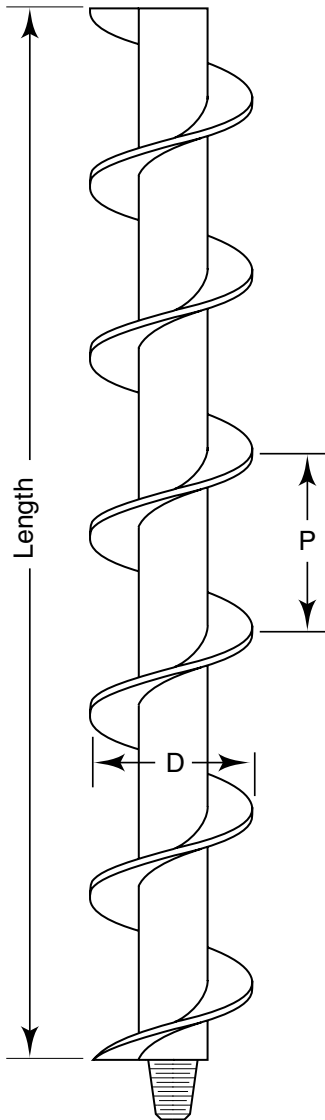

AMWL Hole Size	D-Diam	P-Pitch	Rod I.D.	Rod O.D.	Coupling I.D.	
4-1/2" (114mm)	4" (102mm)	3-1/8" (89mm)	1-3/8" (35mm)	1-3/4" (44mm)	5/8" (16mm)	
NWML Hole Size	4-1/2" (114mm)	4-1/8" (105mm)	3-1/8" (89mm)	2-1/4" (57mm)	2-5/8" (67mm)	1-1/8" (29mm)
6" (152mm)	5-5/8" (143mm)	5" (127mm)	2-1/4" (57mm)	2-5/8" (67mm)	1-1/8" (29mm)	

AWML AUGER

Description	Lb/Kg	Part No.
4-1/2" (114mm) x 3'0" (914mm)	13 (5.9)	007161
4-1/2" (114mm) x 5'0" (1.5m)	22 (10.0)	006271
4-1/2" (114mm) x 10'0" (3.1m)	43 (19.5)	006272

NWML AUGER

Description	Lb/Kg	Part No.
4-1/2" (114mm) x 5'0" (1.5m)	46 (20.9)	006275
4-1/2" (114mm) x 10'0" (3.1m)	81 (36.7)	005655
6" (152mm) x 5'0" (1.5m)	53 (24.0)	006273
6" (152mm) x 10'0" (3.1m)	96 (43.5)	006274

D-P ROCK HEAD



Description	Lb/Kg	Part No.
4-1/2" (114mm), AWML Pin (5 Bits)	8 (3.6)	006290
4-1/2" (114mm), NWML Pin (5 Bits)	9 (4.1)	006291
6" (152mm), NWML Pin (7 Bits)	17 (7.7)	006293

COMPONENT PARTS

Description	Lb/Kg	Part No.
Carbide Insert Bit	3 (1.4)	004627
D-P Bit Punch	4 (1.8)	004628



3-WING CARBIDE INSERT DRAG BIT

Description	Lb/Kg	Part No.
Cutterhead: 4-1/2" (114mm), AWML Pin	7 (3.2)	006765
Cutterhead: 4-1/2" (114mm), NWML Pin	7 (3.2)	006766
Cutterhead: 6" (152mm), NWML Pin	20 (9.1)	006768



AUGER RETRIEVER

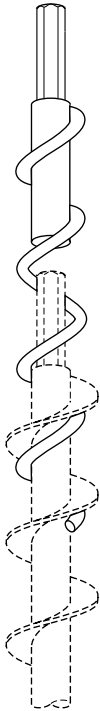

An auger retriever allows catching hold of **HEX-COR™** or standard construction augers lost down the hole. Check hole size of your auger and hex shank size before ordering retriever. Retrievers are used with the continuous flight augers noted in parentheses. **Sizes are identified by the hole size, not actual flight diameter.**

AUGER RETRIEVER - OUTSIDE TYPE

Description	Lb/Kg	Part No.
1 ³ / ₁₆ " (21mm) Hex, 2-1 ¹ / ₂ " (64mm) & 3" (76mm)	7 (3.2)	004912
1-1 ¹ / ₈ " (29mm) Hex, 3-1 ¹ / ₂ " (89mm) & 4-1 ¹ / ₂ " (114mm)	20 (9.1)	004913
1-1 ¹ / ₈ " (29mm) Hex, 5" (127mm)	16 (7.3)	004914
1-1 ¹ / ₈ " (29mm) Hex, 6" (152mm)	20 (9.1)	004915
1-5 ¹ / ₈ " (41mm) Hex, 4-1 ¹ / ₂ " (114mm)	26 (11.8)	004916
1-5 ¹ / ₈ " (41mm) Hex, 5" (127mm)	27 (12.2)	004917
1-5 ¹ / ₈ " (41mm) Hex, 6" (152mm) & 7" (178mm)	30 (13.6)	004918
1-5 ¹ / ₈ " (41mm) Hex, 8" (203mm)	31 (14.0)	004919
1-5 ¹ / ₈ " (41mm) Hex, 10" (254mm)	34 (15.4)	004921
1-5 ¹ / ₈ " (41mm) Hex, 12" (305mm)	36 (16.3)	004922
2" (51mm) Hex, 6" (152mm)	32 (14.5)	003477
2" (51mm) Hex, 8" (203mm)	33 (15.0)	004929
2" (51mm) Hex, 10" (254mm)	35 (15.9)	004930
2" (51mm) Hex, 12" (305mm)	37 (16.8)	004931
2" (51mm) Hex, 14" (356mm)	39 (17.7)	004932

AUGER GUIDE



Auger guides help position the bore hole as vertically as possible. They mount on all Mobile drill rigs and are recommended for safe operation. **Sizes are identified by the hole size, not actual flight diameter.** Give drill rig model and serial number when ordering.

MINUTEMAN DRILLS

Description	Lb/Kg	Part No.
2-1 ¹ / ₂ " (64mm)	3 (1.4)	060256
3" (76mm)	5 (2.3)	060141
3-1 ¹ / ₂ " (89mm)	4 (1.8)	060457
4-1 ¹ / ₂ " (114mm)	9 (4.1)	060283
5" (127mm)	9 (4.1)	060534
6" (152mm)	7 (3.2)	060194

B-80, INSPECTOR SERIES DRILLS

Description	Lb/Kg	Part No.
4-1 ¹ / ₂ " (114mm)	18 (8.2)	212106-01
5" (127mm)	19 (8.6)	212106-02
6" (152mm)	23 (10.4)	212106-03
7" (178mm)	23 (10.4)	212106-04
8" (203mm)	23 (10.4)	212106-05
9" (229mm) & 10" (254mm)	25 (11.3)	212106-06
12" (305mm)	†	212107-27
14" (356mm)	†	212107-28

B-90 DRILL

Description	Lb/Kg	Part No.
4-1 ¹ / ₂ " (114mm)	†	212987-01
5" (127mm)	†	212987-02
6" (152mm)	†	212987-03
7" (178mm)	†	212987-04
8" (203mm)	†	212987-05
9" (229mm)	†	212987-06
10" (254mm)	†	212987-07
12" (305mm)	†	212987-08
14" (356mm)	†	212987-09

ALL OTHER DRILLS

Description	Lb/Kg	Part No.
2-1 ¹ / ₂ " (64mm)	7 (3.2)	005257
3" (76mm)	8 (3.6)	005258
3-1 ¹ / ₂ " (89mm)	9 (4.1)	005259
4-1 ¹ / ₂ " (114mm)	9 (4.1)	005260
5" (127mm)	10 (4.5)	005261
6" (152mm)	10 (4.5)	005262
7" (178mm) & 8" (203mm)	10 (4.5)	005263
9" (229mm)	16 (7.3)	050077
10" (254mm)	18 (8.2)	005265
12" (305mm)	30 (13.6)	050079
14" (356mm)	32 (14.5)	005266

AUGER HOISTING ASSEMBLY



An auger hoisting assembly is used when it is required to pull standard construction or **HEX-COR™** augers vertically utilizing the main hoist. This technique allows the driller to pull more than five feet of auger at a time.

Description	Lb/Kg	Part No.
1 ³ / ₁₆ " (21mm) Hex Socket	2 (.9)	004656
1 ¹ / ₈ " (29mm) Hex Socket	3 (1.4)	004657
1 ⁵ / ₈ " (41mm) Hex Socket	4 (1.8)	004517
2" (51mm) Hex Socket	7 (3.2)	004658

AUGER HOLDER (4-1/4" I.D. HSA Shown)

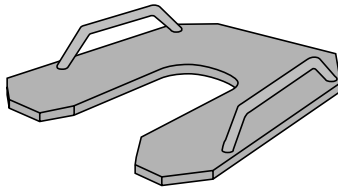

An auger holder is used to temporarily support standard construction or **HEX-COR™** augers during removal of the drill string after soil sampling or monitoring well installation has been completed. The above design is only representative. Other designs may vary.

Description	Lb/Kg	Part No.
1125 Series	4 (1.8)	001328
1500 Series ¹	9 (4.1)	001329
2000 Series	14 (6.4)	001330
2875 & 2625 Series	21 (9.5)	001332

¹Order P/N 01330 for 5" (127mm) and 6" (152mm) hole size augers in this series.

DRIFT PUNCH



AIDS IN THE REMOVAL OF **GROOVE AND U-PINS.**

Description	Lb/Kg	Part No.
Drift Punch.....*		006038

POINTED HAMMER



AIDS IN THE REMOVAL OF GROOVE AND U-PINS.

Description	Lb/Kg	Part No.
Pointed Hammer.....	2 (.9)	005471

AUGER PINCH BAR



USED TO SEPARATE AUGERS.

Description	Lb/Kg	Part No.
Pinch Bar.....	18 (8.2)	212081

MOBILKIT

Contains all the accessory tools required to facilitate auger drilling. Kits include: 1 Retriever, 1 Holder, 1 Extension Rod, 1 Pointed Hammer, 1 Pinch Bar, and 6 U-Pins. Select by auger hex connection size and hole size. Auger Guides (in this section) are ordered separately.

MOBILKIT: 1-1/8" (29mm) Hex

Description	Lb/Kg	Part No.
1500 Series Auger		
3-1/2" (89mm) & 4-1/2" (114mm).....	68 (30.8)	21014-02
5" (127mm).....	68 (30.8)	21014-03
6" (152mm).....	68 (30.8)	21014-04

MOBILKIT: 1-5/8" (41mm) Hex

Description	Lb/Kg	Part No.
2000 Series Auger		
4-1/2" (114mm).....	102 (46.3)	21014-05
5" (127mm).....	102 (46.3)	21014-06
6" (152mm) &		
7" (178mm).....	102 (46.3)	21014-07
8" (203mm).....	102 (46.3)	21014-08
2875 Series Auger, 10" (254mm).....	132 (59.9)	21014-09
3875 Series Auger, 12" (305mm).....	132 (59.9)	21014-10

MOBILKIT: 2" (51mm) Hex

Description	Lb/Kg	Part No.
2625 Series Auger		
6" (152mm).....	120 (54.4)	21014-11
8" (203mm).....	120 (54.4)	21014-12
10" (254mm).....	120 (54.4)	21014-13
12" (305mm).....	120 (54.4)	21014-14
14" (356mm).....	120 (54.4)	21014-15